

# Multimode Gateway (Zigbee 3.0 + BLE Mesh) instruction

## Contents

---

<u>Feature</u> .....	2
<u>Parameter</u> .....	3
<u>Indicator status</u> .....	3
<u>App control details</u> .....	4-8
<u>APP installation</u> .....	4
<u>Pairing network</u> .....	4-5
<u>Add sub device (lights)</u> .....	6-7
<u>Sharing device</u> .....	8
<u>Attention</u> .....	9

## Feature

It's super mini smart gateway with multi communication protocol. The gateway communicates with icloud and smart phone via Wi-Fi network. User can review status of connected Zigbee or BLE MESH(SIG) devices, add and reset devices, third party control and sub device group control via **Tuya smart APP**. It has wide application for smart life.



Zigbee 3.0 standard protocol



Smart phone APP control



BLE MESH(SIG) protocol



Third party voice control



Compatible with Zigbee 3.0 and BLE MESH(SIG) products



Remote control



Home sharing function



Biorhythm control\*



Tap-to-run & automation



Music rhythm



Timer function



Sleep/awake plan



customized scene



Sub device group control

\* **Biorhythm:** imitate variation of natural brightness and color temperature, make us to enjoy natural lighting feature.

## Parameter

Model No.: ZB-Box3

Input: 5V  1A (Type-C)

Working temperature: -10~40°C

Wireless standard: Wi-Fi IEEE 802.11b/g/n 2.4GHz, Zigbee 802.15.4, Bluetooth 5.0



Connected device(Max): Bluetooth Mesh + BLE SIG+Zigbee device (128pcs totally)

only support 3pcs device for single bluetooth connection

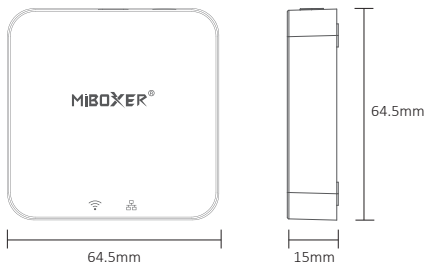
Control distance: 30m (indoor), 100m+ (outdoor)



## Indicator status

Device status	 Indicator	 Indicator
Pairing with WiFi	Flash slowly	On
Connected with WiFi	On	On
Add zigbee device	On	Flash quickly
WiFi offline	Off	On

## Pairing with Network (5G router is useless)

### 1). Download an install “Tuya Smart” APP

Search “Tuya Smart” in apple or google store, or scan QR code directly.

Please creat account if using in the first time.



### 2). Wire gateway with power source, enable smart phone to connect with WiFi.

### 3). Standby pairing with Network

 Indicator flashes slowly (1 times within 3 seconds), please long press “SET” 5 seconds if indicator don't flash slowly.

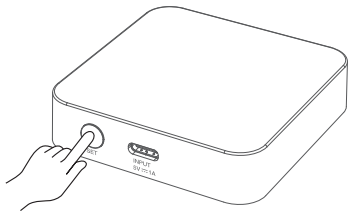

4). Click “+” in APP

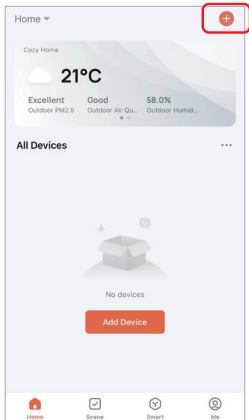

- 5). Select “Gateway Control”
- 6). Find out “Multimode Gateway (BLE+Zigbee)”
- 7). Finish every step based on instruction

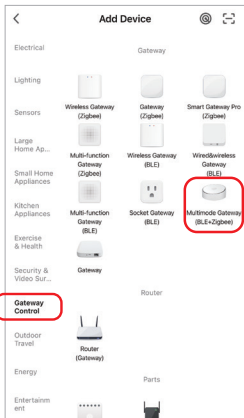

## Add sub device

1). Click connected gateway, For example, “Multimode Gateway”

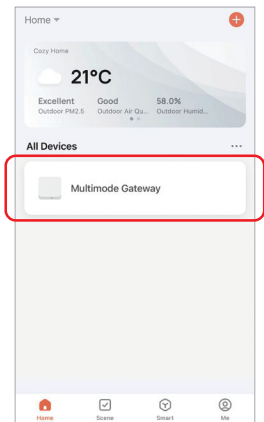

2). Click “Add subdevice”

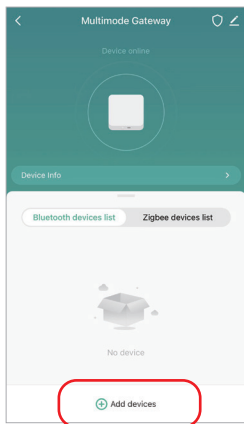

3). Enable lights to be standby pairing status (review instruction of lights)

4). Find out “Add new devices”

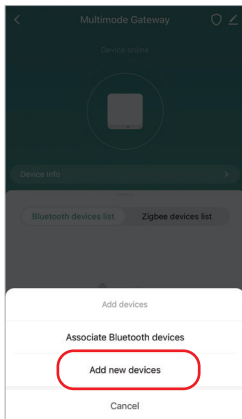

5). Devices will be searched after a while  
(max connected 128pcs devices)

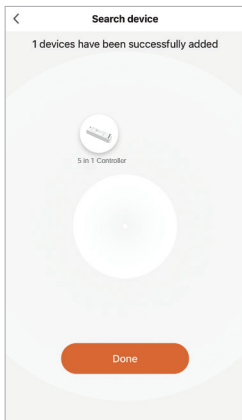

# Home Sharing

1). Click 

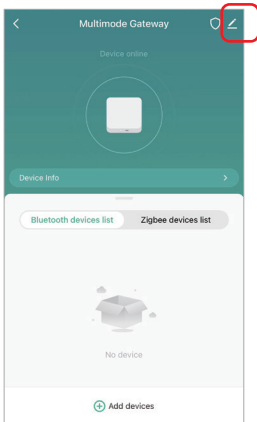

2). Click “Share Device” to finish it

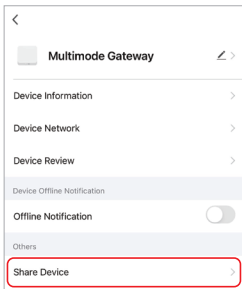



## Attention

1. Stay away from magnetic area while doing installation, or it will affect control distance.
2. Don't install device in the place where is strong sun shine, high temperature or humidity, working temperature is -10~40°C.
3. Don't disassemble device if you are not expert, or device damaged simply.



Scan QR code or review video from following link  
[https://miboxer.com/light/video/zigbee\\_bue.html](https://miboxer.com/light/video/zigbee_bue.html)



Made in China